

SCALE 1:2

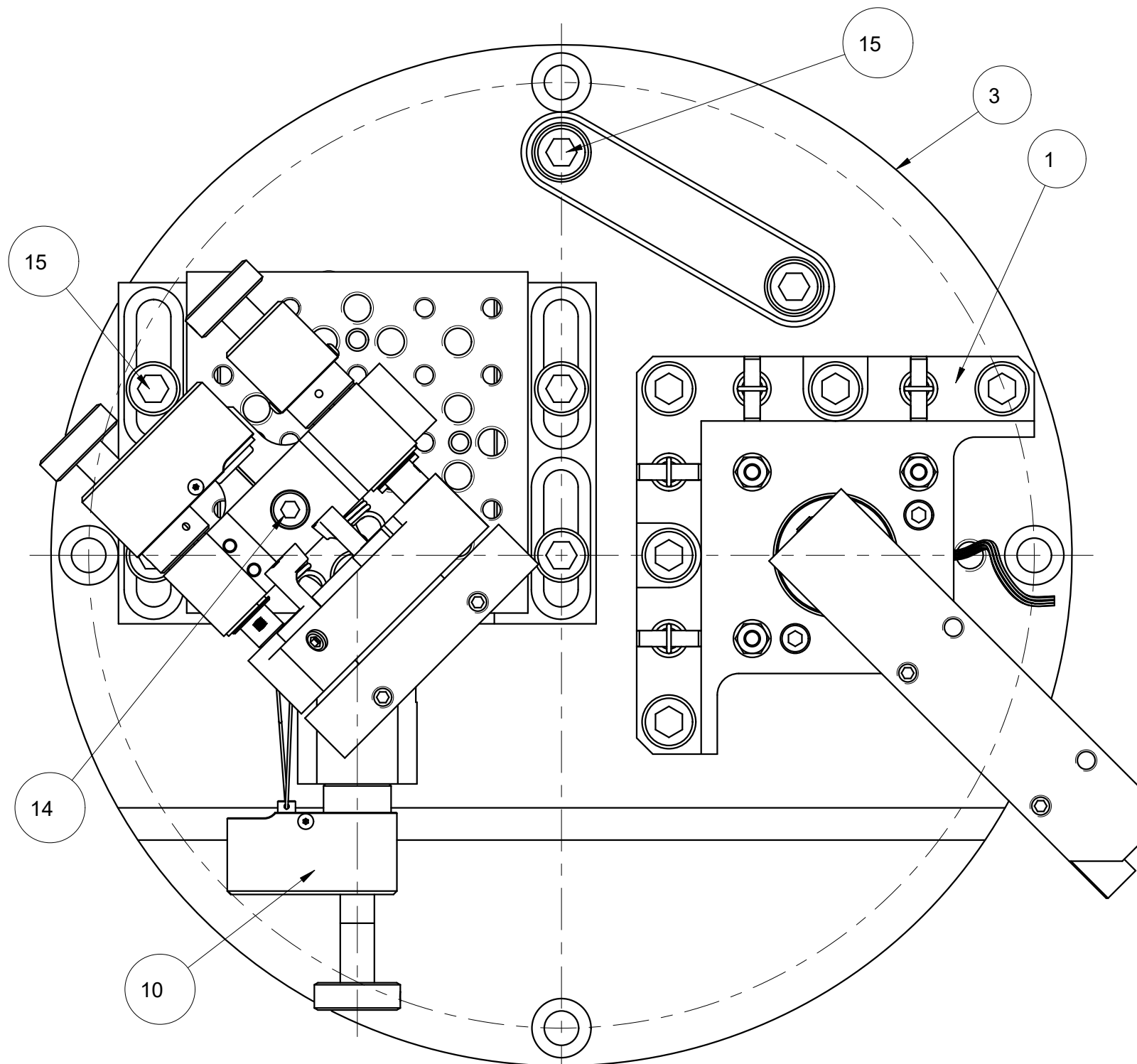

1 ASSEMBLY

EXCLUDED FROM SUPPLY
EXCLUDED FROM SUPPLY
EXCLUDED FROM SUPPLY
EXCLUDED FROM SUPPLY
EXCLUDED FROM SUPPLY

15	VITE TCEI UNI5931 M6X10	8	A4
14	VITE TCEI UNI5931 M4X10	2	A4
13	VITE STEI ESTR.PIANA UNI5923 M6x14	2	A4
12	VITE STEI ESTR.PIANA UNI5923 M4x6	4	A4
11	NEWPORT 1.00" LIN. TRANSL. STAGE 9067-X	1	
10	NEWPORT 1.0" Picomotor Actuator 8302-UHV	1	
9	NEWPORT 8821-AC-UHV STAGE	1	
8	MIRROR THORLAB PFSQ20-03-M01	1	
7	EDMUND OPTICS 75x75x7.5mm	1	
6	1226330404 MIRROR FRAME	1	A 6082
5	1226330403 90° ANGLE BRACKET	1	A 6082
4	1226330402 HANDLE	1	A 6082
3	1226330401 BASE PLATE	1	A 6082
2	1226330205 ROD	2	AISI 304
1	12263305 PLANE MIRROR KINEMATIC MOUNT	1	
POS.	N. DISEGNO	DENOMINAZIONE	Q.TA' MATERIALE
General Tolerance / Tolleranza generale: UNI EN 22768/1 - M			
Lenght and Diam.	0.00 6.00 30.0 120 315 1000 2000 >	Angles	0.4
Lungh. e Diam.	6.00 30.0 120 315 1000 2000 4000 4000	Angoli	0.25
Tolerance	±0.1 ±0.2 ±0.3 ±0.5 ±0.8 ±1.2 ±2.0 ±3.0	±0.5°	0.2/100
PROG.	A. DE LUISA	0.2/100	0.2/100
MODEL	A. DE LUISA	0.2/100	0.2/100
DIS.	A. DE LUISA	08-Nov-2016	0.2/100
CNR - IOM		MATERIALE	TRATTAMENTO
LABORATORIO TASC		MIRROR ASSEMBLY "A"	
A2	SCALA 1:1	Nr. DISEGNO	FOGLIO
12263404		1	DI 1
		Pro/ENGINEER	